

OTICON | Opn

Opn™ miniRITE rechargeable solution



A quick guide
to your new
rechargeable
hearing aid

oticon
PEOPLE FIRST

Congratulations on your **rechargeable hearing aid**

This booklet will guide you through the usage of the Opn miniRITE rechargeable solution to ensure that you get off to a good start with your hearing devices.

It is recommended that you read the instruction booklet provided with the Opn miniRITE hearing aid, as well as the instruction booklet provided with the rechargeable box.

We hope you will enjoy the convenience of rechargeable batteries and be assured that you will never be out of power as you can always use standard zinc-air batteries for a back up.

Your Opn miniRITE rechargeable hearing aid

WHAT IT IS

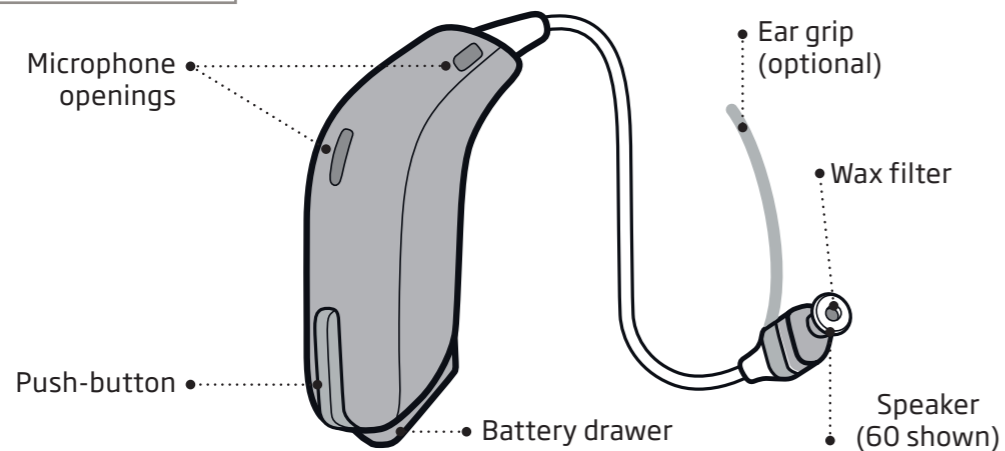

WHAT IT DOES

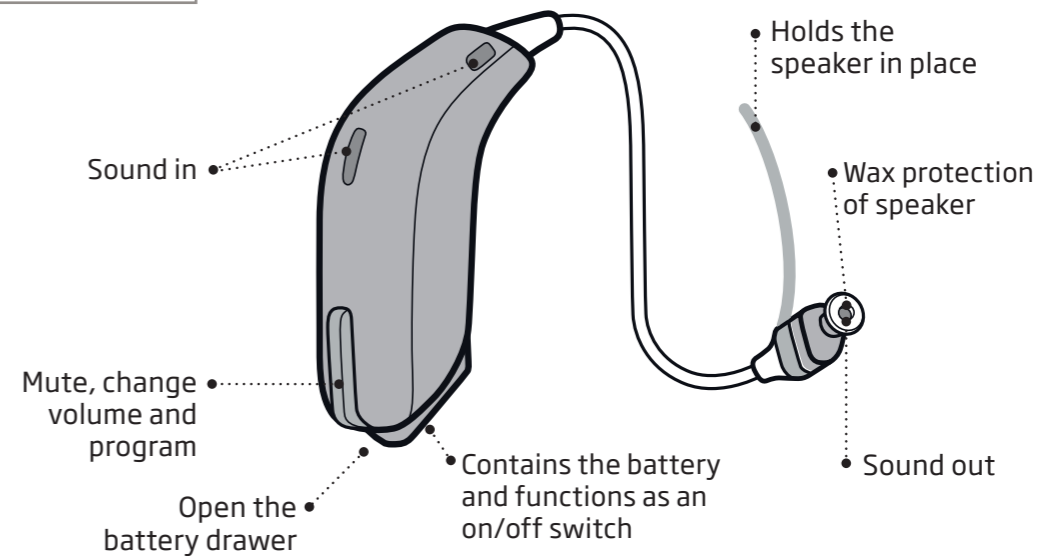

NOTE

Open the battery drawer if you want to turn off your hearing aid.

How to replace batteries

1. Open the battery drawer
2. Place the rechargeable battery inside the battery drawer (gold side facing upwards)
3. Close the battery drawer

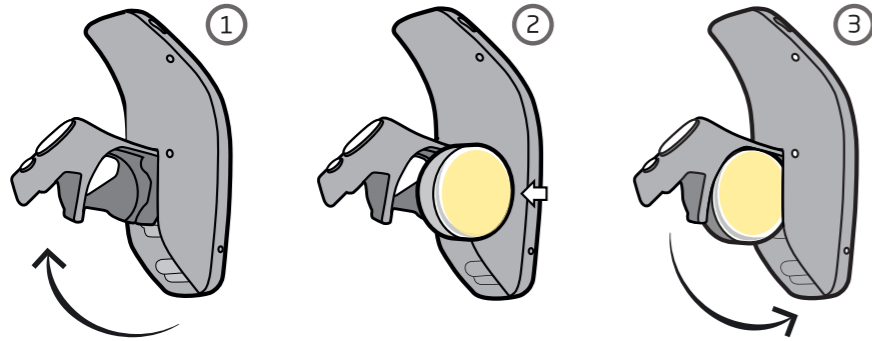

NOTE

You can use disposable zinc-air batteries in your rechargeable Opn miniRITE. Do not place instruments with disposable batteries in the charger. However if you do by mistake, the light indicating the devices are charging will not turn on.



How to use the rechargeable batteries

Proper use will help to extend the life of your batteries.

- Charge the batteries regularly before wearing them. Overnight might be the most convenient time. You can't overcharge the batteries. When the green light turns solid the instruments are fully charged.
- Commercial hearing aid drying kits can be used to help manage moisture. Talk to your HCP if you need more information.
- Charge the batteries at temperatures between 50°F (10°C) and 104°F (40°C).
- Don't place the batteries in the charger if it is unplugged; this will drain the batteries.
- If you don't intend to use your hearing aids for several days, remove the batteries.
- Your batteries should last for approximately one year, and they can easily be replaced by your hearing care professional at that time.

Battery life examples

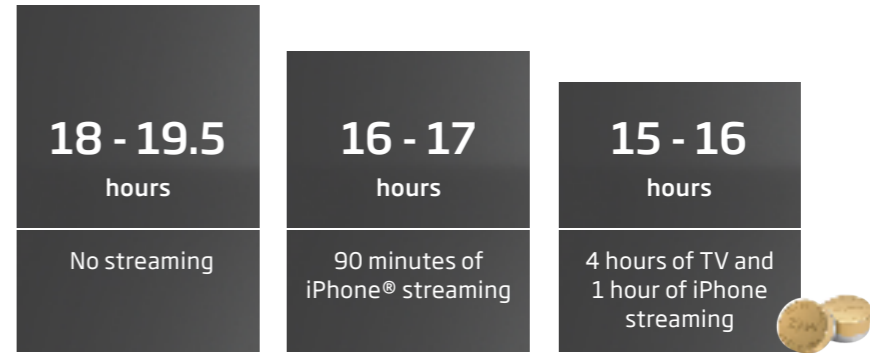

Daily hours of usage depend on level of hearing loss and lifestyle.

Apple, the Apple logo, iPhone, iPad, iPod touch, and Apple Watch are trademarks of Apple Inc., registered in the U.S. and other countries. App Store is a service mark of Apple Inc. Android, Google Play, and the Google Play logo are trademarks of Google Inc.

How to charge your hearing aids

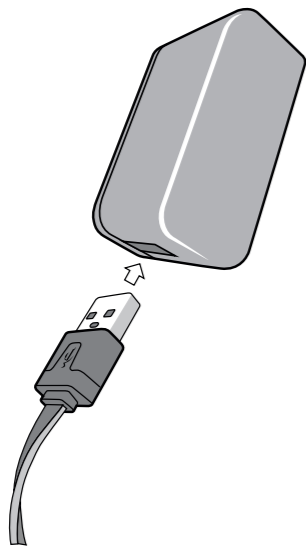

Plug the USB into the charger, then plug the adapter into the wall.

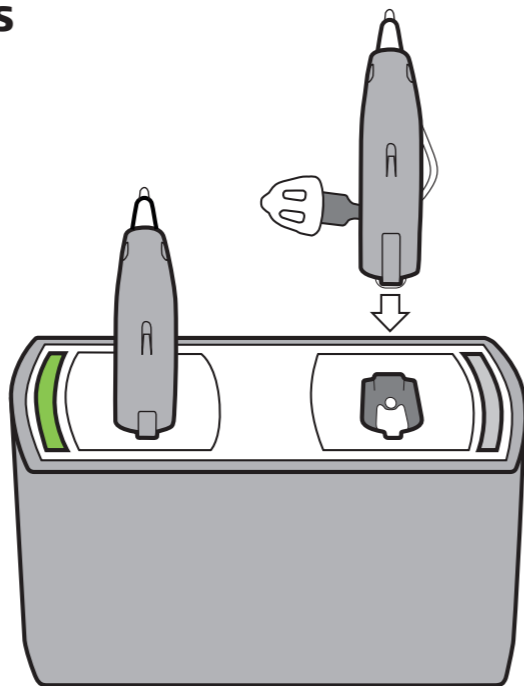

Place your hearing aids into the charger dock. You will see a green light blinking when the hearing aids start charging.

LED indications

- No light - the hearing aid is not inserted in the charger correctly, or the charger is not plugged in
- Blinking green light when charging
- Solid green light when completely charged
- Red light when warning

If your hearing aids are fully drained, you should recharge them overnight (approximately 7 hours).

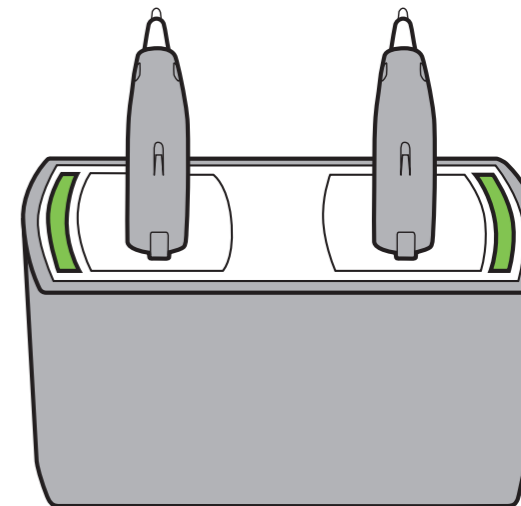

NOTE

The hearing aid turns off automatically while charging.

Troubleshooting guide

Charger lights	Possible cause	Solution
No lights	The hearing aid is not inserted into the charger correctly, or the charger is not powered.	Remove the hearing aid(s) and place in correct position. Verify that the USB cable is properly connected to the USB wall adapter. Verify that the USB wall adapter is functional by plugging in a different USB device.
One or both lights solid red	The battery won't charge.	Verify that the hearing aid battery is a ZPower rechargeable battery.
Both lights flashing red	Temperature is out of range. Charging is paused until temperature is within range.	Move the charger to an environment between 50°F (10°C) and 104°F (40°C).

If none of the above solutions work, consult your hearing care professional for assistance.





www.oticon.com

oticon
PEOPLE FIRST